

# DS-2CE5582P(N)

## 600 TVL DIS Indoor Dome Camera

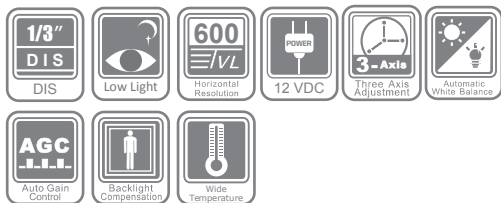

### Key features

- 600 TVL Horizontal Resolution
- Electronic Day/Night
- 2.8/3.6/6mm Fixed Lens
- 0.1 lux /F1.2, 0.28 lux /F2.0
- Wide Operating Temperature Range:  
-40°C to 60°C(-40°F to +140°F)

### Dimensions

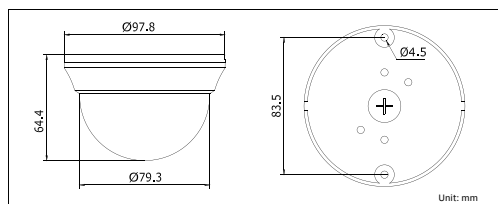

DS-2CE5582P(N)	
Camera	
Image Sensor	1/3" DIS
Signal System	PAL/NTSC
Effective Pixels	720 (H) × 480 (V)
Min. Illumination	0.1 Lux @ (F1.2, AGC ON) 0.28 Lux @ (F2.0, AGC ON)
Shutter speed	PAL: 1/25 s to 1/15,000 s NTSC: 1/30 s to 1/15,000 s
Lens	3.6 mm @ F2.0 (2.8mm, 6 mm, optional)
	Angle of view: 70.6° (3.6 mm)
Lens Mount	M12
Angle Adjustment	Pan: 0 - 355°, Tilt: 0 - 90°, Rotation: 0 - 355°
Horizontal Resolution	600 TVL
Synchronization	Internal synchronization
Video Output	1Vp-p composite output (75 Ω/BNC)
S/N Ratio	More than 52 dB
General	
Working Temperature/Humidity	-40 °C - 60 °C (-40 °F - 140 °F) Humidity 90% or less (non-condensing)
Power Supply	12 V DC ± 10%
Power Consumption	Max. 1 W
Dimensions	Φ 97.8 x 64.4 mm (Φ 3.85" x 2.54")
Weight	300 g (0.66 lbs)

### Available models

PAL: DS-2CE5582P  
NTSC: DS-2CE5582N